

| REVISION HISTORY | | | | |
|------------------|-----|-------------|------|----------|
| ZONE | REV | DESCRIPTION | DATE | APPROVED |
| | | | | |

BODY BUILDERS NOTES

1.

DIMENSIONS ARE FOR REFERENCE ONLY
2.

REFER TO ACTUAL VEHICLE FOR MEASUREMENTS

UNLESS OTHERWISE SPECIFIED
DIMENSIONS ARE IN MILLIMETERS.
TOLERANCES ARE:
DECIMALS ANGLES
.X +/- 0.8 +/- 2 DEGREES
.XX +/- 0.25
DO NOT SCALE DRAWING
THIRD ANGLE PROJECTION

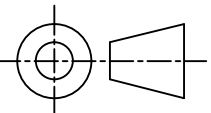

CONTRACT NO.
GXR77VU-HDSH / FH-GXDJJ-A11

| APPROVALS | DATE |
|---------------------|----------|
| DRAWN N SALLÉN | 18/10/14 |
| CHECKED S HUMPHRIES | 20/10/14 |
| ENGR R RODRIGO | 22/10/14 |
| DESIGN ACTIVITY | |

ISUZU
ISUZU AUSTRALIA LIMITED

TITLE
MY14 GXD PRIME MOVER

| | | | |
|-----------------------|------------------|----------------------------------|-----------------------|
| SIZE A3 | CAGE CODE N/A | DWG NO. FH-MY14-GXDPRIMEMOVER | REV. A |
| SCALE NOT TO SCALE | CALC.WT | ACT.WT | SHEET SHEET 1 OF 1 |